

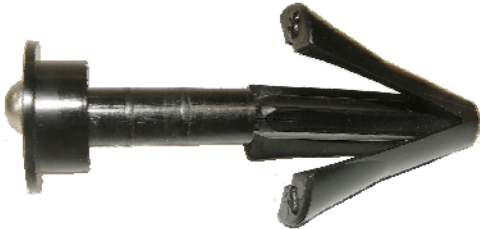

MASTER ANCHOR WINGITS—MAW35 WORLD'S STRONGEST FASTENER!



Congratulations! You are using the World's Strongest Wall Fastening System. MASTER Anchors will not loosen over time OR from directional forces.

PARTS—Stainless Steel Screw; Tape; Structural, Fire Retardant Plastic Faceplate and Wing — (Optional Stainless Steel Hook Plate may also be included.)

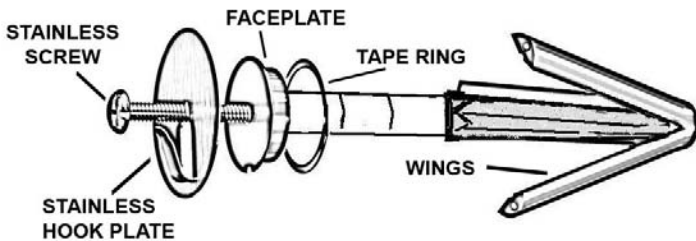

Install Instructions:

⇒ Watertight application—peel Tape Ring off liner, place Tape on Faceplate and remove paper cover.



⇒ For mirrors and pictures, use the optional Stainless Hook Plate

Surface Preparation—Determine where to install MAW—Drill 3/4" hole using the Apache200 (rated 200 holes in ceramic wall tile). The standard MASTER Anchor is used in wall substrates up to 1.3" thick - call for other sizes.

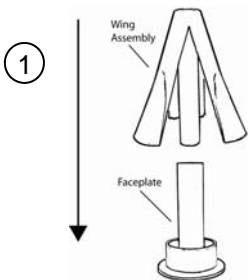

1. Insert the WINGS into the FACE-PLATE (the tubes interlock).

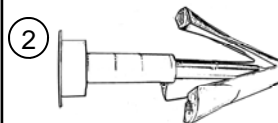

2. Extend the WingIt to full Length.

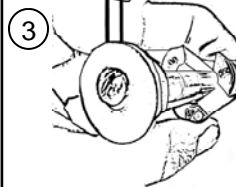

3. Compress and insert the WINGS into the holes.

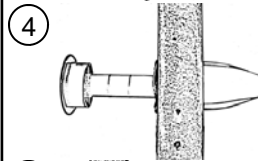

4. WINGS should be FLUSH with the wall surface.

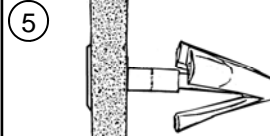

5. Pop WingIt through the hole by pushing on the Faceplate.

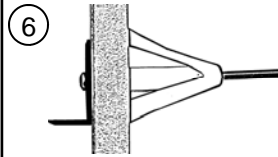

6. Using the enclosed 3.5" Stainless Steel Screw, Attach the grab bar to the WingIt.

NOTE—for individual mounting points where the Object will be subject to considerable torque (rotational forces) - use at least two MASTER Anchors.

Note: Strength and stability are greatly affected by projection off the wall surface and the length of interaction with the wall surface. Call us @ 877.894.6448 for guidance.

WingIts are designed to be used in vertical walls only—DO NOT USE IN CEILINGS.

Typical Uses include but not limited to:

- ALL KINDS OF ACCESSORIES AND DISPENSERS, BRACKETS, BATHROOM ACCESSORIES, CLOSET RACKS, COAT HOOKS, CLOCKS, DOOR BUMPERS, DIAPER CHANGING TABLES, EMERGENCY LIGHTING, FIRE EXTINGUISHERS, GARMENT BAG HOOKS, HAND DRYERS, HEAD BOARDS, IRONS AND IRONING BOARDS, JUMBO PICTURES, KICK PLATES AND KICK RAILS, LIGHTING—WALL LIGHTS AND SCONCES, MIRRORS, MEDICINE CABINETS, MAIL BOXES, NEON SIGNAGE, PICTURES, RACKS—TOWEL, SHOWER RODS, SIGNS, SHELF—TOWEL, TOWEL BARS, TELEPHONES, TOWEL WARMERS, WINDOW TREATMENTS

Call WingIts @ 877.894.6448 to review specific installations.

Use the OFFSET MASTER Anchor when the hole in the Object being mounted is less than 1/2" from the edge of the Object. This will allow the FACEPLATE to be completely concealed by the Object.

