

WINGITS®

MASTER Anchor™

Super Duty Fastener

Model:
MAWSD

World's Strongest Fastener®



Part Numbers:

MAWSD35

Plastic Anchor with Stainless Steel Standoff and Screw



Features / Benefits

Standard Hollow Wall Anchor

- Rated up to 300 lbs.*
- NEVER Loosens
- Structural plastic construction
- Water-resistant and Fire-retardant
- Handles vector forces 360°
- Patented worldwide
- Uses Stainless Steel standoff and 8-32 x 3-1/2" screws

INSTALLATION IS AS EASY AS ...

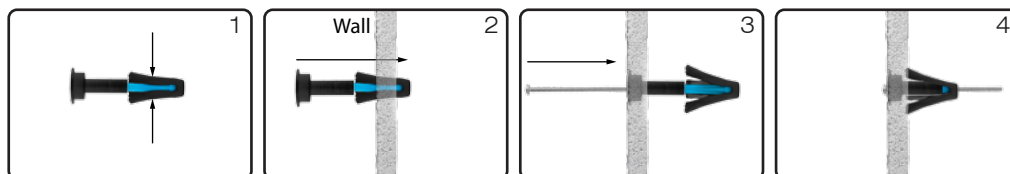

Install WINGITS® MAWSD35 Fastener Quickly and Easily with the APACHE200 Carbide Drill Bit



Industrial Grade Carbide Drill Bit

- Rated at 200 holes in ceramic wall tile
- Drills holes through ceramic wall tiles in seconds
- No hammer drill required - this precision cutting drill does all the work
- Industrial grade carbide cutting tool
- Engineered for standard and cordless drills
- Designed for ceramic, marble and plaster

MECHANICAL DATA
Height: 1" (2.54cm)
Length: 1" (2.54cm)
Projection: 3.5" (8.89cm)
PRODUCT COMPOSITION
Structural plastic construction with stainless steel standoff and screw.
MODALITY
Use: Must be used in vertical walls only.
INSTALLATION
WINGITS® MAWSD35 are used for hollow wall construction and come standard with a stainless steel 3.5" screw for walls up to 1 1/4" thick.