

WINGITS® MASTER Anchor™ Fastener

Model:
RESGBW

Part Numbers:
RESGBW35
Plastic Anchors with Stainless Steel Screws

World's Strongest Fastener®



Features / Benefits

- Exceeds ADA Guidelines and ALL Building Codes
- Eliminates the need for Blocking
- Waterproof and Fire-resistant
- Rated up to 600 lbs. in Drywall with Tile
- Used to Install **WINGITS®** Grab Bars
- Patented Worldwide

AS EASY AS ...

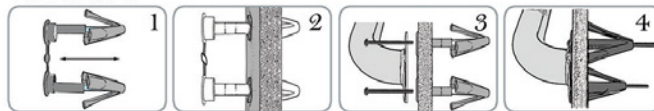

Install WINGITS® RESGBW35 Fastener Quickly and Easily with the APACHE200 Carbide Drill Bit



Industrial Grade Carbide Drill Bit

- Rated at 200 holes in ceramic wall tile
- Drills holes through ceramic wall tiles in seconds
- No hammer drill required - this precision cutting drill does all the work
- Industrial grade carbide cutting tool
- Engineered for standard and cordless drills
- Designed for ceramic, marble and plaster

MECHANICAL DATA
Height: 3" (7.62cm)
Length: 2.5" (6.35cm)
Projection: 3.5" (8.89cm)
PRODUCT COMPOSITION
Structural plastic construction with Stainless Steel screws.
MODALITY
Use: Must be used in vertical walls only.
INSTALLATION
WINGITS® RESGBW35 are used for hollow wall construction. WINGITS® RESGBW35 come standard with a stainless steel 3.5" screw for walls up to 1 1/4" thick.
RECOMMENDED INTEGRATION
It is recommended that WINGITS® RESGBW35 be used for WINGITS® Grab Bars.

RESGBW35_SpecSheet_20141110

WINGITS®

Installation Instructions RESGBW35

Commercial Grab Bar Fastening System Installation Guide. WINGITS® Grab Bar Fastening Systems

Exceed Building Codes For Grab Bars In The Following Wall Substrates:

- 5/8" Drywall - Painted or Wallpapered
- 1/2" or 5/8" Drywall with Tub Surrounds
- 1/2" or 5/8" Drywall with Tile, Marble or Stone
- 1/2" or 5/8" Drywall with any Panel Types including Fiberglass, Faux Marble, Acrylic and Plastics
- Multiple Layers of Drywall, Plaster and Lathe
- 1/4" Acrylic/Fiberglass Tub Surrounds over Drywall
- Most Wall Panels, All Masonary Type Boards, with or without Decorative Panels

NEVER INSTALL ANY FASTENER INTO WET OR DETERIORATING WALLS Structural Blocking Must Be Used In PLAIN 1/2" DRYWALL When Attempting To Meet Commercial Building Codes.

NOTE: For Maximum Safety and to meet ADA Requirements, Grab Bars should be Installed Horizontally 33-36" from the floor. Before You Install:

- Verify the length of the grab bar by measuring from the inside of one flange to the outside of the other.
- WINGITS® come standard with a Stainless Steel 3.5" machine screw for walls up to 1" thick.
- To ensure adequate clearance, a stud finder should be used to verify there are no studs within the area where the WINGITS® will be installed.

Make sure that there is at least 1.5" away from the edge of the stud. If concerned, drill a pilot hole and insert a piece of wire in the shape of an "L" - twirl the wire to make sure there is nothing in the way.

- Clean wall surface



INSTALLATION INSTRUCTIONS

1. PEEL the 1/4" liner (scored) off the tape and fold up until properly placed.



2. Determine location of Grab Bar and mark length on the wall, remove center hole, then place tape with the center hole over mark. Stick tape to the wall remove the remaining liner.



3. Use the tape as a template, Drill out two 3/4" holes.



4. Once holes are drilled remove tape liner.



5. Insert the **WINGS** into the **FACEPLATE** (the tubes interlock). Extend the WINGITS® to full length.

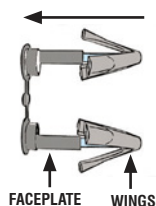

9. Using the enclosed 3.5" **STAINLESS STEEL SCREWS**, attach the object to the WINGITS®.



6. Compress and insert the **WINGS** into the drilled hole.

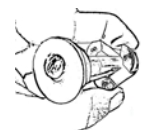

7. WINGS should be flush with the wall surface.



8. Pop WINGITS® through the hole by pushing on the **FACE PLATE**.

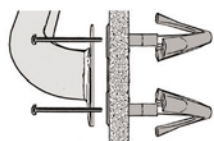

Grab Bar installed with RESGBW35 WINGITS®



NOTE: Strength and stability are greatly affected by projection off the wall surface and the length of interaction with the wall surface. Call us at 877.894.6448 for guidance. WINGITS® are designed to be used in vertical walls only. **DO NOT USE IN CEILINGS.**

View Installation Videos at: www.wingits.com