

# WINGITS® WAVE™

## Structural Corner Foot Rest

**Model:**  
**WFR66**

**Part Numbers:**

**WFR66PS**  
Polished Finish

**WFR66SN**  
Satin Finish



Contemporary design combines with structural engineering resulting in a Foot Rest with:

- Structural 18/8 Stainless Steel with Rolled Edges
- Ergonomic Design for comfortable footing in all positions
- Bright Mirror and Satin Nickel Finishes standard
- Includes 3M Waterproof Tape, 100% Waterproof Installation
- Includes **2 FREE MASTER Anchors™ Super Duty MAWSD35** World's Strongest Fastener™ for Guaranteed Installation
- Requires Grab Bar(s) installation as hand-hold for stability

**Note:** Grab Bar **MUST** be used with FOOT REST for liability and safety issues

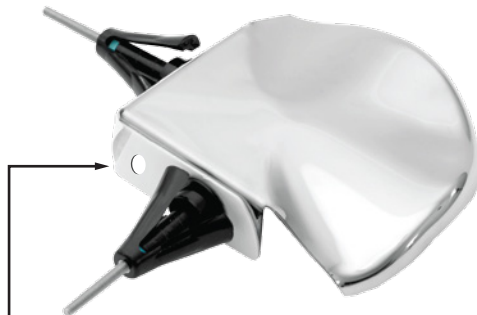

Plastic Anchor & Steel Screw



<b>MECHANICAL DATA</b>
<b>Height:</b> 1.8" (4.5cm)
<b>Length:</b> 6.5" (16.5cm)
<b>Projection:</b> 6" (15.25cm)
<b>PRODUCT COMPOSITION</b>
Entire product is 18/8 (304) stainless steel.
<b>MODALITY</b>
<b>Use:</b> Wall Installation.
<b>INSTALLATION</b>
<b>WingIts® WAVE™</b> Foot Rests are designed to be <b>installed into adequate structural blocking</b> or with <b>WingIts® MASTER Anchor™ Super Duty Fasteners (MAWSD35)</b> .
<b>RECOMMENDED INTEGRATION</b>
For hollow wall construction, it is recommended that <b>WingIts® MASTER Anchor™ Super Duty Fasteners for WAVE™</b> Foot Rests (MAWSD35) are used with this product.

# WINGITS®

**TOP**

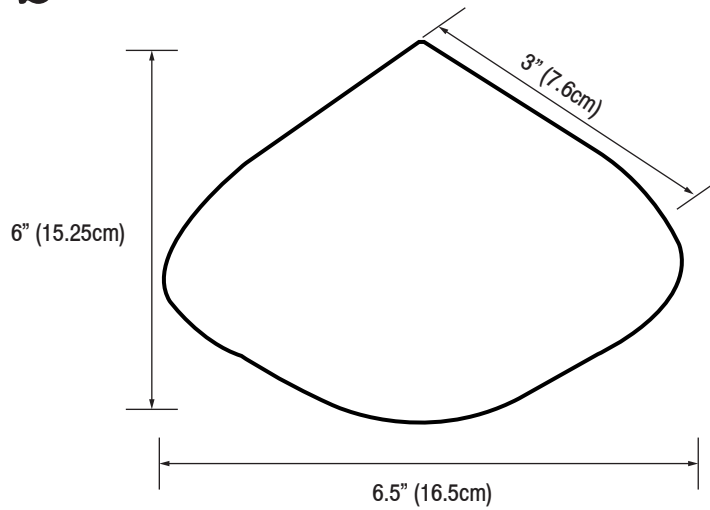

**SIDE**

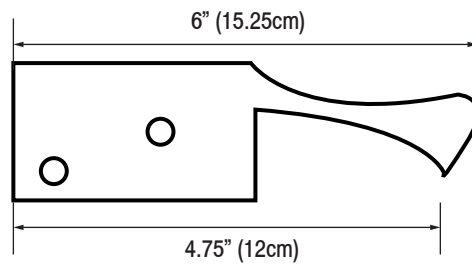

**FRONT**

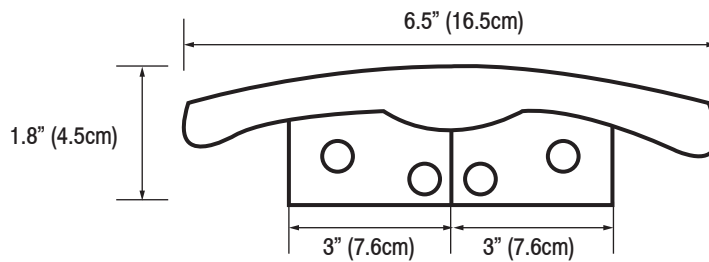

**BACK**

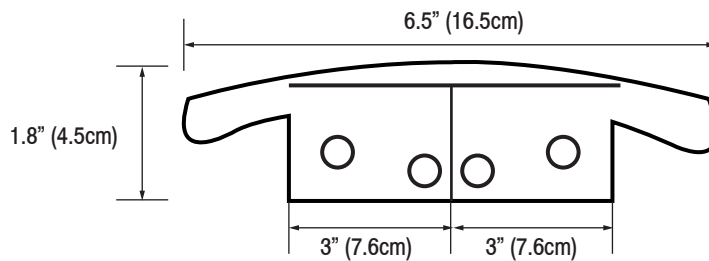

**INCLUDED HARDWARE**

