

WINGITS®

MODERN Elegance™

Grab Bar Fastener

Model:
GBWME

Part Numbers:

GBWME40
Stainless Steel Fastener with
Plastic Face Plate and 4"
Stainless Steel Screw



AS EASY AS ...

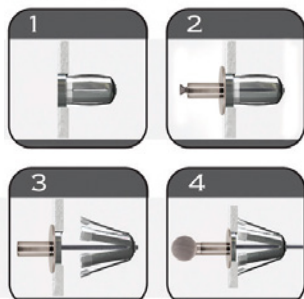

Features:

- Exceeds ADA Guidelines and ALL Building Codes
- NEVER Loosens - World's Strongest Fastener®
- Water Resistant and Fire Retardant
- Used to Install WINGITS® Designer Grab Bars
- Rated up to 800lb in Drywall with Tile
- Eliminates the need for Blocking

MECHANICAL DATA

Length: 2.75" (70mm)
Height: 2.75" (70mm)
Depth: 4" (102mm)

COMPOSITION

18-8 (304) Stainless Steel with Plastic Face Plate

INSTALLATION

WINGITS® Grab Bar Fasteners (GBWME40) are rated up to 800lb in drywall with tile and designed to install WINGITS® MODERN Elegance™ Grab Bars.



Industrial Grade Carbide Drill Bit

- GBWME40 installs quickly and easily with the APACHE200 (WA200GT54)
- Drills holes through ceramic wall tiles in seconds - use cordless drill
- Designed for ceramic, marble & plaster

Installation Instructions GBWME40

WINGITS® MODERN Elegance™ Grab Bar Fastening System Installation Guide WINGITS® Grab Bar Fastening Systems Exceeds Building Codes For Grab Bars In The Following Wall Substrates:

- 5/8" Drywall - painted or wallpapered
- 1/2" or 5/8" Drywall with tub surrounds
- 1/2" or 5/8" Drywall with tile, marble or stone
- 1/2" or 5/8" Drywall with any panel types including fiberglass, faux marble, acrylic and plastics
- Multiple layers of Drywall
- Plaster and lath
- 1/4" acrylic / fiberglass tub surrounds
- Most wall panels, all masonry type boards, with or without decorative panels

WINGITS® MODERN Elegance™ uses Indicator Points to simplify installation.

1. Remove the stand-offs to expose the **INDICATOR POINTS** on the accessory.
2. To ensure adequate clearance, a stud finder should be used to verify there are no studs within the area where the WingIts™ will be installed. Make sure that there is at least 1.5" away from the edge of the stud.
3. Place the accessory in the preferred location and **push on the accessory to mark the points where stand-offs will be mounted.**

GBWME40

Installing MODERN Elegance™ Grab Bars

1. Drill 1.25" hole on the marks by the **INDICATOR POINTS**.
2. Peel one side off of waterproof tape and adhere around drilled hole in wall.
3. Remove center **SCREW** completely.
4. Insert **SCREW** through **STAND-OFF** and rethread into fastener.
5. Insert the WingIts™ into the wall.
6. Push the **SCREW** head all the way into the **STAND-OFF** until the wings "POP" behind the wall.
7. Pull on **STAND-OFF**, remove tape liner - keep **STAND-OFF** away from wall as you tighten.
8. Attach Grab Bar and tighten set screws.

AS EASY AS ...

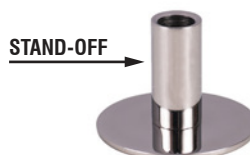
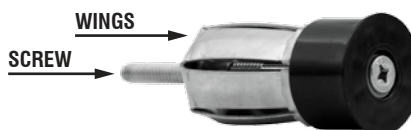
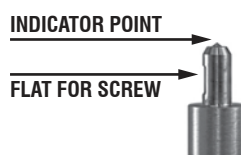
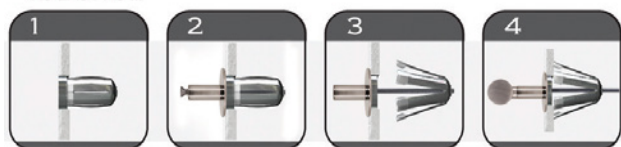

View Installation Videos at:
www.wingits.com

View Installation Videos at: www.wingits.com

Toll Free: 877-894-6448 www.wingits.com sales@wingits.com