

# WINGITS®

## SHEER Squared™

### GRAND Pivoting Toilet Paper Holder

Model:

# WSSQGPTPH

Part Numbers:

WSSQGPTPHPS  
Polished Finish

WSSQGPTPHSN  
Satin Finish

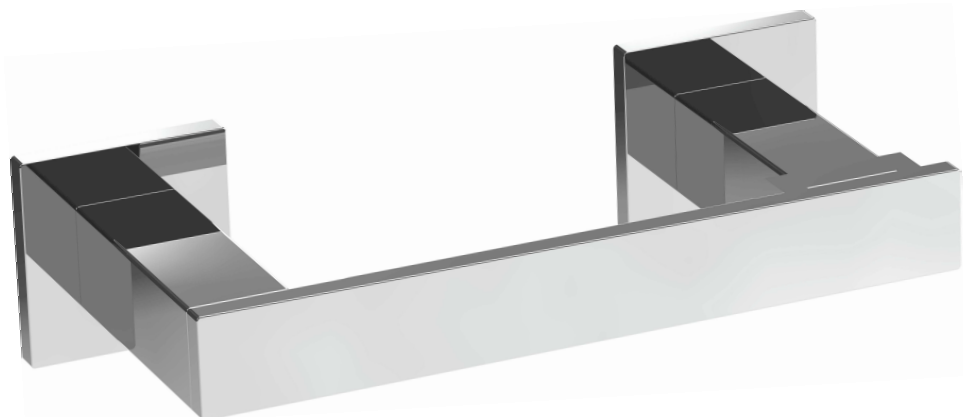

Radiused Edges for Safety

#### Features:

- SHEER Beauty, Functionality & Durability
- Substantial Form and Seamless Construction
- Pivoting Motion Allows for Easy Toilet Paper Replacement
- Hand Polished 18-8 (304) Solid Stainless Steel Results in Consummate Aesthetics that are Unique and Captivating



Wall

Installed with  
Optional WINGITS®  
Fasteners

<b>MECHANICAL DATA</b>
Length: 8" (203mm) Depth: 3.25" (83mm) Height: 2" (51mm)
<b>COMPOSITION</b>
18-8 (304) Stainless Steel
<b>INSTALLATION</b>
Includes Stainless Steel Screws to Install into <b>Adequate Structural Blocking</b> . Includes 3M® VHB Waterproof Tape. Can Be Installed with WINGITS® Fasteners when blocking is not available.
<b>RECOMMENDED INTEGRATION</b>
Install into <b>Adequate Structural Blocking</b> or with WINGITS® Fasteners. WINGITS® SHEER™ design is available in all Bath Accessories.

**Top**

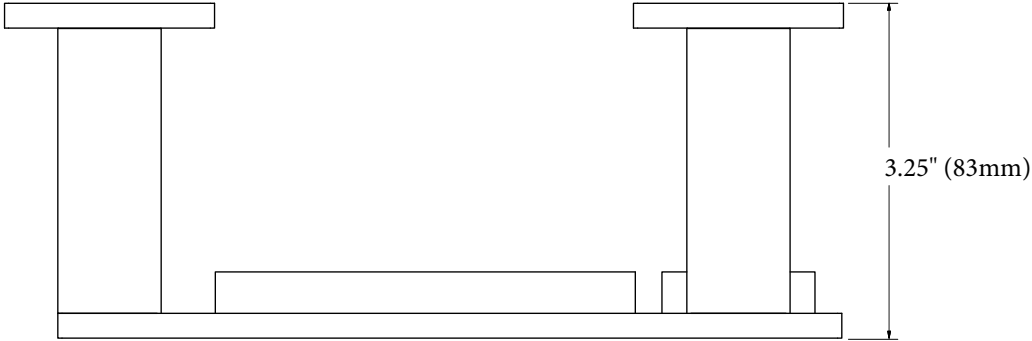

**Front**

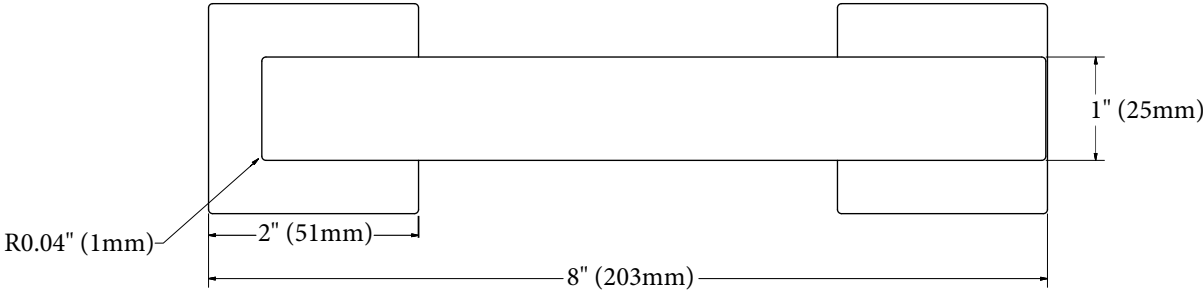

**Bottom**

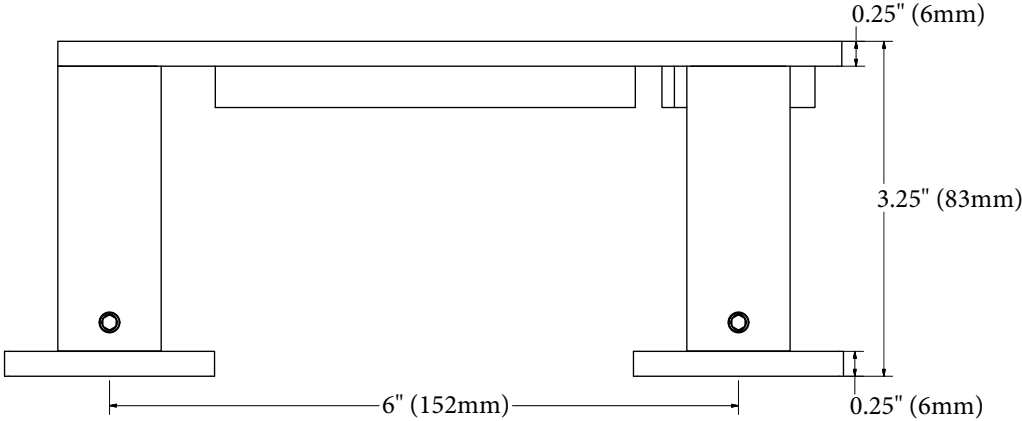

**Included Hardware**

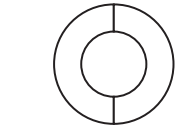

3M<sup>®</sup> Waterproof Tape (2)



2.5" S/S Screw (2)

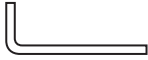

Allen Wrench (1)



Set Screw (2)

**Optional Hardware  
(Sold Separately)**

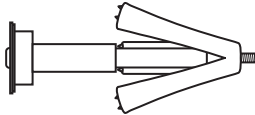

WINGITS<sup>®</sup> MASTER Anchor™ (MAW45)  
(2)